

House #5

12 by 12 inches finished
12 ½ by 12 ½ inches unfinished

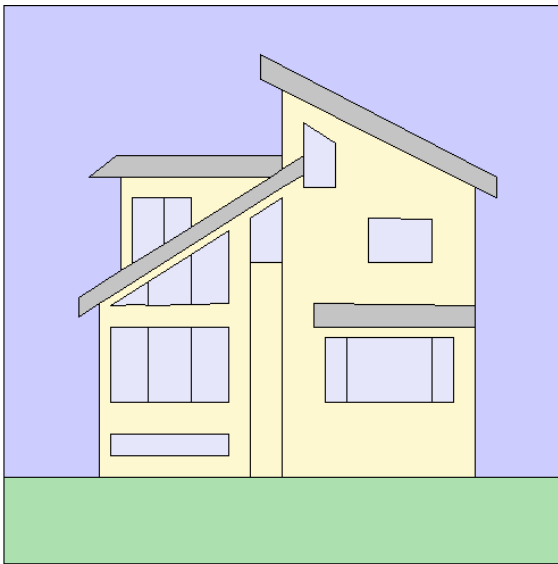

This house looks a little boring until you take a close look at the siding - the angle matches the roof, with a strip under the centre window that is vertical. It gives the house real character. Also note that the door is on the left side of the house, not on the side that faces the street. The house being above the street will have had quite a view until they started building double and triple story new houses on the low side of the street. Then the view of the Fraser will not be as interesting!

The eaves are not pieced in - applique them afterwards.

Due to all the angles, a lot of this house will be paper pieced.

- Sky
- Pieces for Paper Pieced sections A and C.
- 1 - 7 by 4 inches (D)
 - 1 - 3 ½ by 1 inches (E)
 - 1 - 2 ¾ by 7 ½ inches (F)
 - 1 - 2 ½ by 7 ½ inches (G)

- Siding
- Pieces for Paper Pieced sections A, B, and C
- 2 - 3 ¼ by 1 inches (H)
 - 1 - 3 ¼ by 1 ¼ inches (I)
 - 1 - ¾ by 4 ½ inch (J)
 - 1 - 1 by 4 ½ inch (K)
 - 1 - 4 ½ by 1 ¼ inch (L)
 - 1 - 2 ½ by 1 ½ inch (M)
 - 1 - 1 ½ by 1 ½ inch (N)
 - 1 - 5 by 1 ¼ inches (O)
 - 1 - 1 ½ by 5 inches (P)
 - 1 - 5 by 1 ¼ inches (R)
 - 1 - 1 ½ by 2 inches (S)
 - 1 - 1 by 2 inch (T)
 - 1 - 5 by 2 ¼ inches (U)

- Windows
- 1 - 3 ¼ by 2 ¼ inches (W1)
 - 1 - 3 ¼ by 1 inches (W2)
 - 1 - 2 by 1 ½ inches (W3)
 - 1 - 3 ½ by 2 inches (W4)

- Front yard
- 1 - 13 by 2 ½ inches (X)



- Roof
- 1 - 1 by 5 inches (V)
 - 2 - 1 ½ by 4 ¾ inches (W)
 - 2 - ½ inch finished strips for eaves - 7 inches each

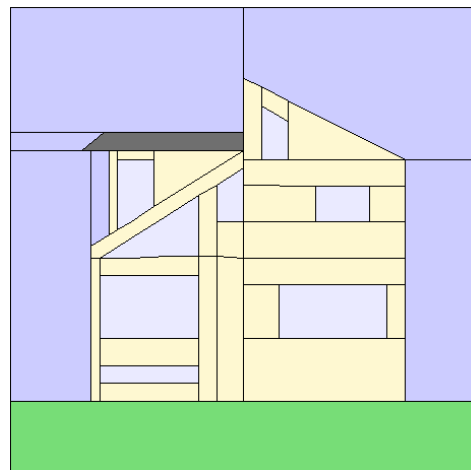

First order of business - Finish off the paper pieced sections A, B and C.
Sew Sections B and C together.

Sew Sky piece E to Roof V together with a bias seam. There is an extra length in these two pieces for the seam. Set this aside for now - trim it to size just yet.

Sew Siding piece H to window W1, then add Siding piece I, Window W2, and another Siding piece H.

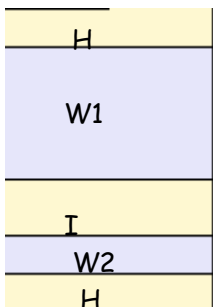

This section will measure $3 \frac{1}{4}$ by $4 \frac{3}{4}$ inches siding piece J to the left of the piece, and K, then L to the right

now measures $4 \frac{1}{2}$ by $4 \frac{3}{4}$ inches.

Sew these windows below the section BC, then add sky piece F on the left.

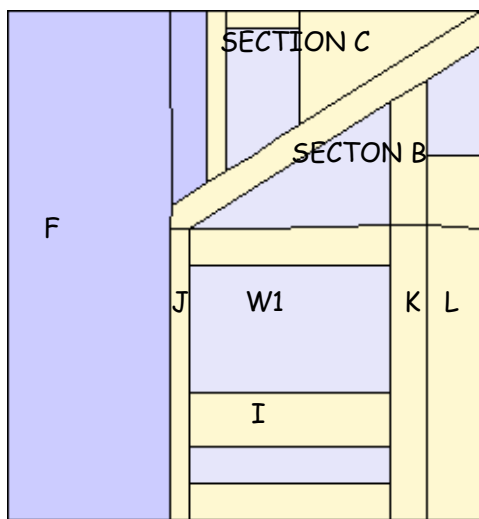

Now add the EV roof to the placing the seam so it has a bit of Finally add the sky piece D above

This house half should measure 7 inches.

Sew siding piece M to the left of Window W3, and siding piece N to the right.

This will measure 5 by $1 \frac{1}{2}$ inches.

Add siding piece O above the window, and siding piece P below it.

This piece will measure 5 by $3 \frac{1}{4}$ inches

Next, sew the two roof sections W right sides together on one long side, and both short sides^P this will be inserted as a 3D awning.

Sew siding piece R below P, inserting the awning lining up so it sits slightly more than $\frac{1}{4}$ inch in from the right side (to allow for the seam). Your piece will now measure 5 by $4 \frac{3}{4}$ inches.

Sew siding piece S to the left of Window W4, and siding piece T to the right. piece U below the window section. This piece measures 5 by $3 \frac{3}{4}$ inches.

Now, start stacking this side of the house.

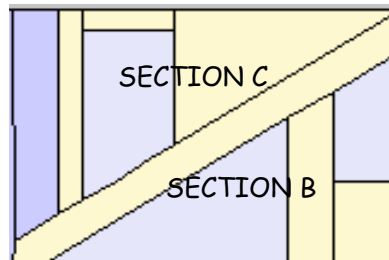

little don't

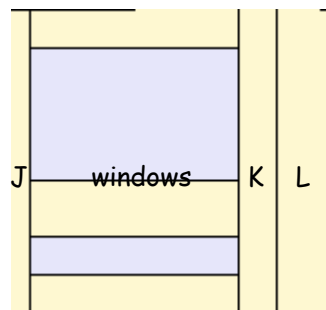

inches. Add siding piece

This piece

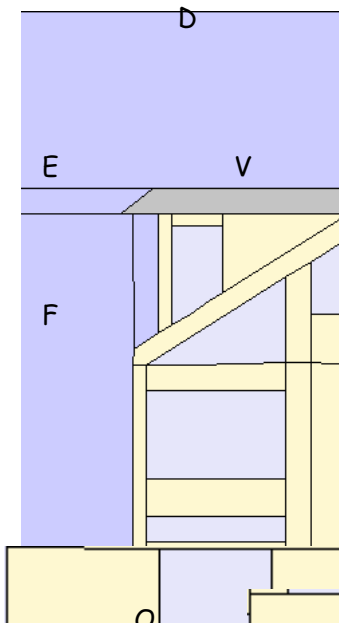

section, overhang. the roof.

by $11 \frac{1}{2}$

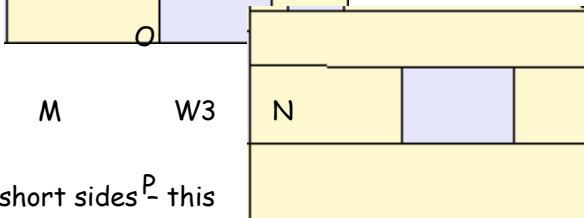

M W3

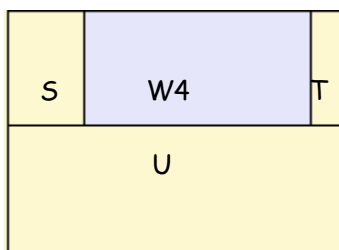

Add siding

U

Sew the then the window W3 above the W4 section.
Add the sky section G to the right of the house.

This section measures 7 by $7\frac{1}{4}$ inches.

Add the Paper pieced section A to the top of this half of the house.

Now you have both halves done, sew these together, and add the front yard below.

Once you have the embellishing done - trim to $12\frac{1}{2}$ by $12\frac{1}{2}$ inches.

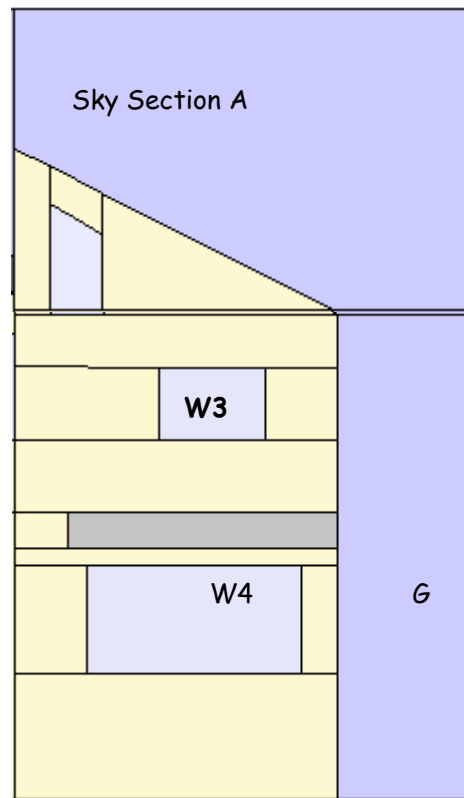

A note on the eaves:

The eave sections should be finished to $\frac{1}{2}$ inch. The left eaves should be centered on the seam between Sections B and C. It extends from a little beyond the house on the left, to just touching the top window. The right eaves sits just above Section A, and extends on both ends. Check out the picture on the front page!!

Have fun adding foliage to the front yard - maybe a big tree behind the house.

Once your block is finished, add sashing to the left side, then add your 4 by 12 inch filler block. This block could be a tree house, or some additional foliage or whatever goes with your finished quilt. Maybe you have a piece of fabric that fits in perfectly - or a picture you have printed. You can also add the sashing to the bottom of the block.

House #5 - Piecing Diagram

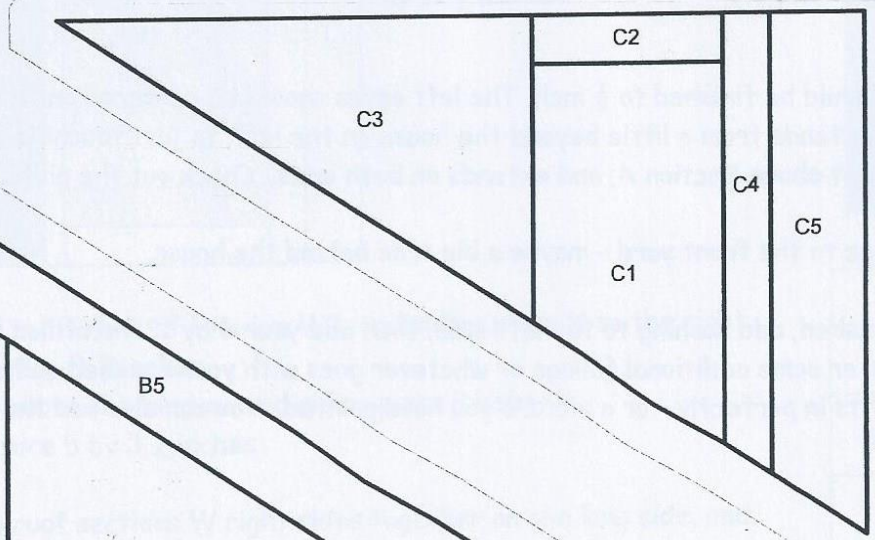
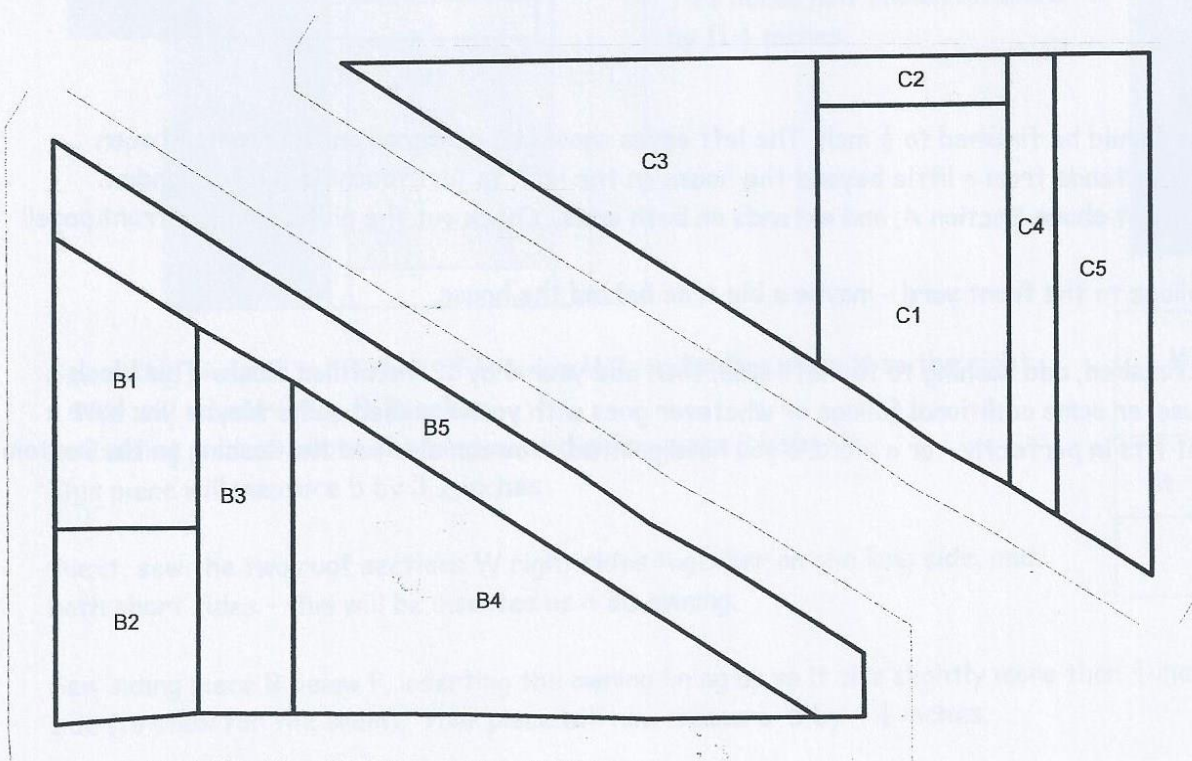
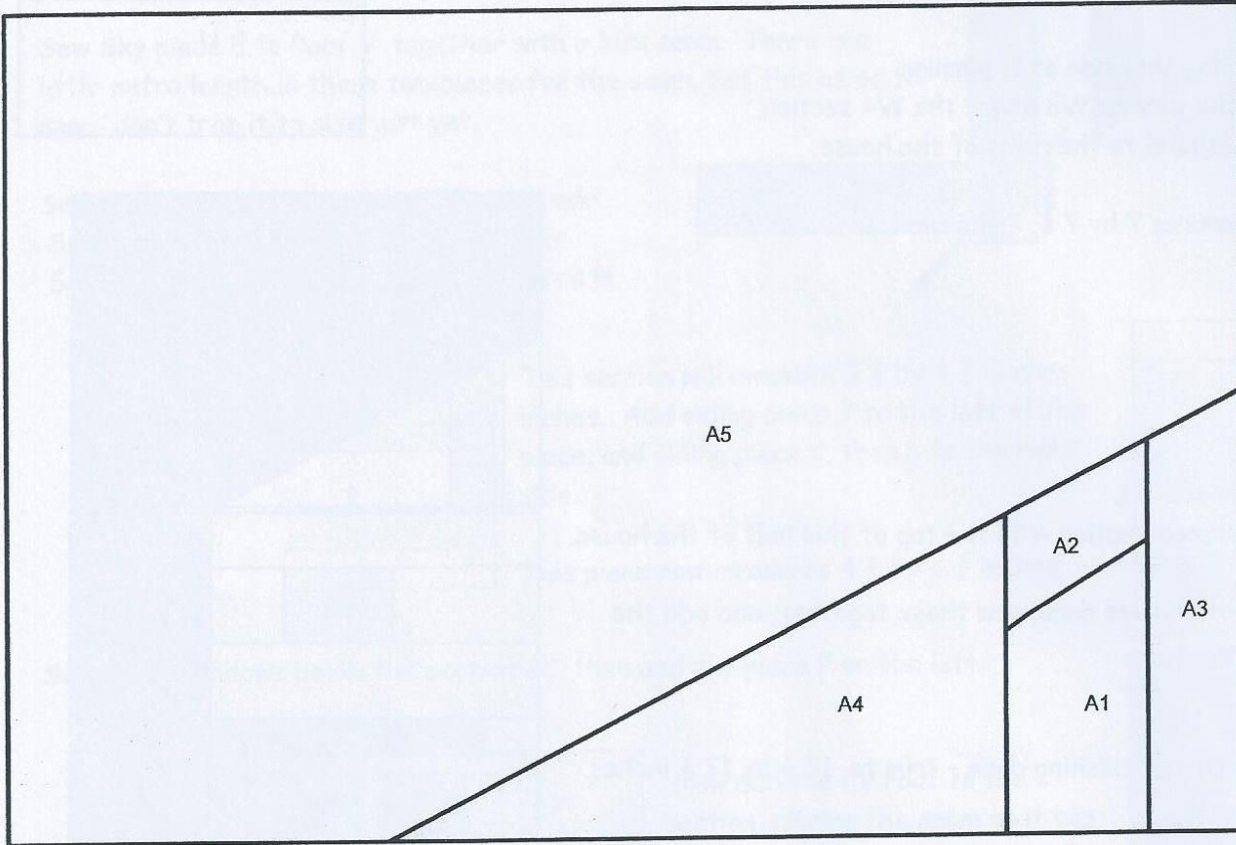

2 inches