

House 11

12 by 10 inches finished

12 ½ by 10 ½ inches unfinished



This house is quite simple to piece, but all those lattice strips are only 1/8th of an inch. I suggest you embroider them, use narrow ribbon - or find a piece of fabric with a stripe. Of course in your house you might not like the lattice look!

Fill those window boxes with bright flowers, and maybe add a planter on the porch - check out the photo for ideas

Like all the blocks, there is a little added so that once you have the embellishment done, you can trim it down to size.



Sky

2 - 2 by 4 ½ inches (Z)

Plus pieces for paper pieced sections A, B, C

Roof - Paper pieced sections A and B

Siding

2 - 1 ¼ by 3 ½ inches (D)

1 - 3 by 1 ¼ inches (E)

1 - 3 by 1 ½ inches (F)

1 - 1 by ¾ inches (G)

1 - 1 ½ by 3 ¼ inches (H)

1 - ¾ by 1 ½ inches (I)

1 - 1 ¼ by 1 ¾ inches (J)

1 - 2 by 1 ¼ inches (K)

1 - 1 ¼ by ¾ inches (L)

1 - 1 ¾ by 3 ¼ inches (M)

1 - 2 ¾ by 1 ¼ inches (N)

1 - 2 ¾ by 1 ½ inches (O)

Windows:

1 - 3 by 1 ¾ inches (P)

1 - 1 by 1 ½ inch (Q)

1 - 2 ¾ by 1 ¾ inches (R)

Door:

1 - 1 ¼ by 2 ¾ inches (S)

Brickwork around steps

2 - 1 ¼ by 1 ½ inches (V)

2 - 1 by ¾ inch (W)

4 - 5/8 inch squares (really tiny connectors!)

Front Yard

1 - 13 by 2 inches (T)

Front Steps

1 - 3 1/8 by 1 ½ inches (U)

Base

1 - 3 ¼ by 1 ½ inches (X)

1 - 3 ¾ by 1 ½ inches (Y)

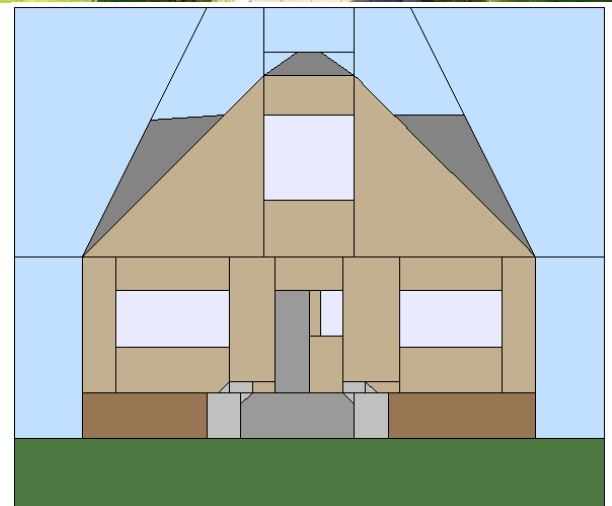

First paper piecing the roof pieces Sections A, B, and C. Sew them together as shown in the diagram below. This will measure $5\frac{3}{4}$ by 13 inches.

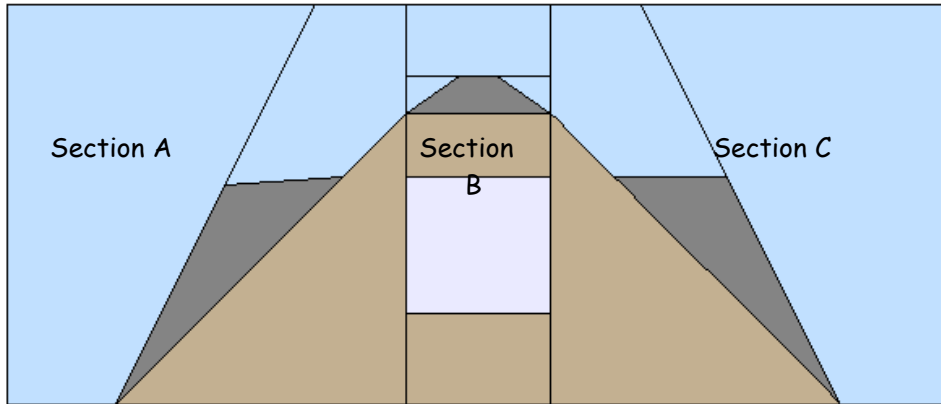

TIP: Windows - 'Dress' the windows before you piece them - you might want to cut them a bit larger, and add the details, then cut them down to size.

We'll start on the left and move to the right on the main floor.

First, sew a tiny brick connector onto the lower right corner of Siding F. Then sew Siding E to the top of window P, and siding F to the bottom of the window. Add siding D to the left of the window section. This will measure $3\frac{3}{4}$ by $3\frac{1}{2}$ inches.

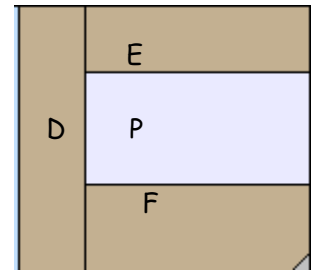

Now for a fiddly bit - Sew brickwork W to siding G. This will measure $\frac{3}{4}$ by $1\frac{1}{2}$ inches. Sew Siding H above it, then sew this to the right side of the window. Your piece measures $3\frac{1}{2}$ by $4\frac{3}{4}$ now.

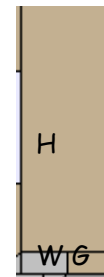

Next do the front door section - sew siding I to the left of window Q, then sew siding J below the window section. This will measure $1\frac{1}{4}$ by $2\frac{3}{4}$ inches. Add the door to the left to measure 2 inches by $2\frac{3}{4}$ inches.

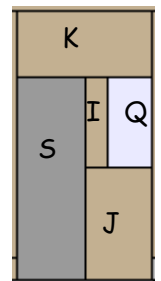

Add the door to the left, and sew siding piece K above the entire section. This will measure 2 by $3\frac{1}{2}$ inches.

For the right side, we need to add another tiny connector to Siding piece L (it's tiny I know).

Sew this to the right of section W. Then add Siding M above this unit $1\frac{3}{4}$ by $3\frac{1}{2}$ inches.

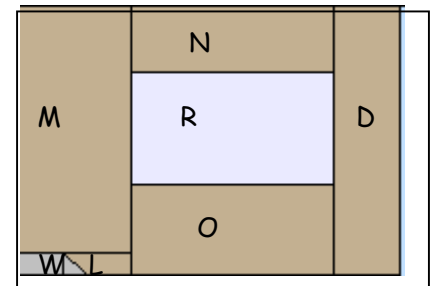

Sew Siding N above the window R, and siding O below the window. Add the Siding M piece to the left and that last siding D to the right. This will measure 5 by $3\frac{1}{2}$ inches.

Sew the windows to either side of the door section.

For the base, add the last two connectors to the top corners of the stairs (U).
Now, add a V section to either side of the stair. You may want to put some lines across the steps to indicate that they are steps.



With the base X added to the left, and base Y added to the right, you now have a section $9\frac{1}{2}$ by $1\frac{1}{2}$ inches

Sew this to the bottom of the windows section and you have the house pretty much finished.

Now add the sky sections Z to each side of the house, Your piece should now be 13 inches wide and $4\frac{1}{2}$ inches tall.

Add the roof and you are done the piecing. Add the Front yard, and you are almost done.

Put lots of flowers in the window boxes, and around the front door, and have fun.

Once the block is finished, trim it to $12\frac{1}{2}$ by $10\frac{1}{2}$.

House #11 - Piecing Diagram

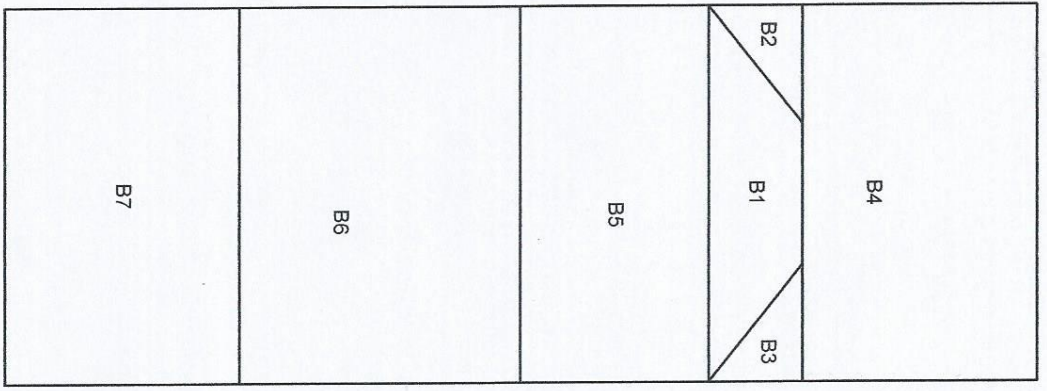
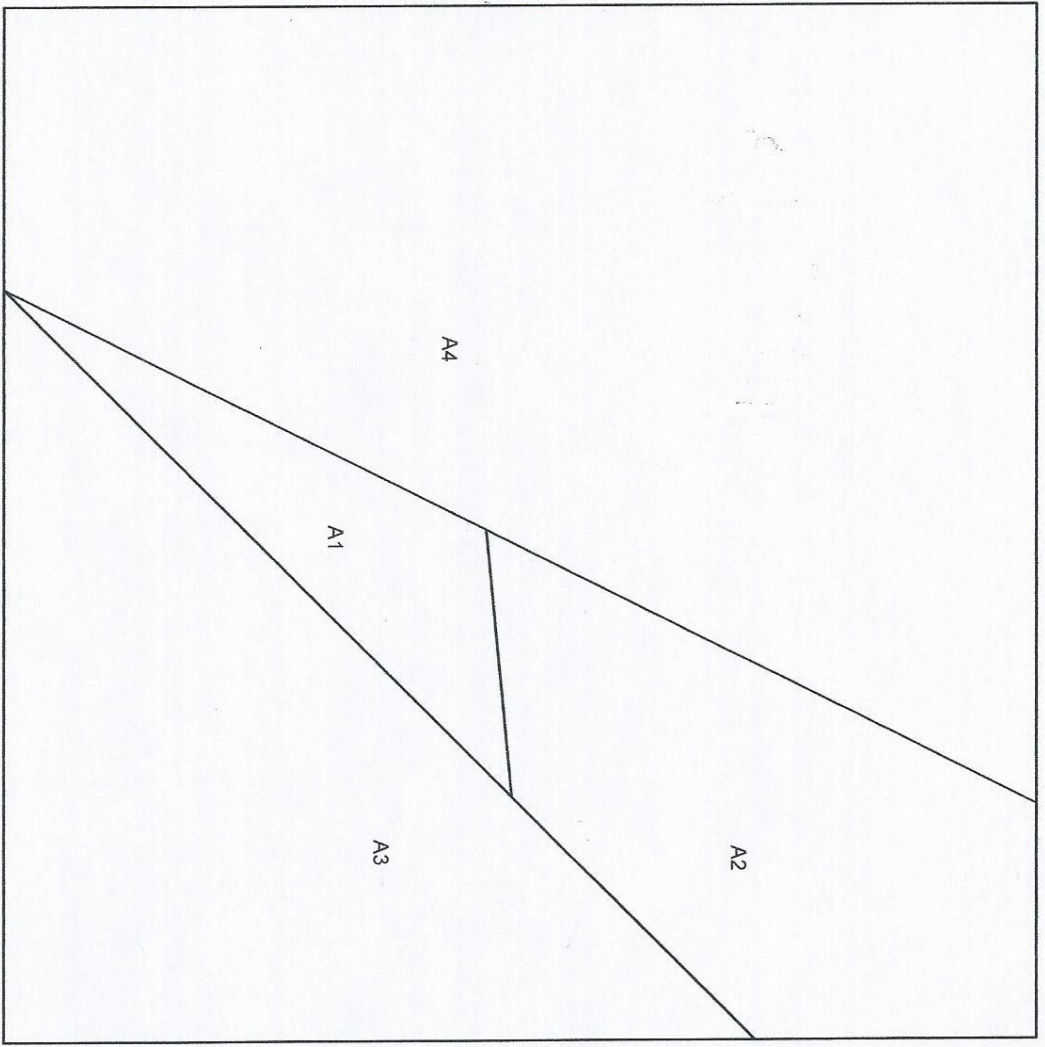

2 inches

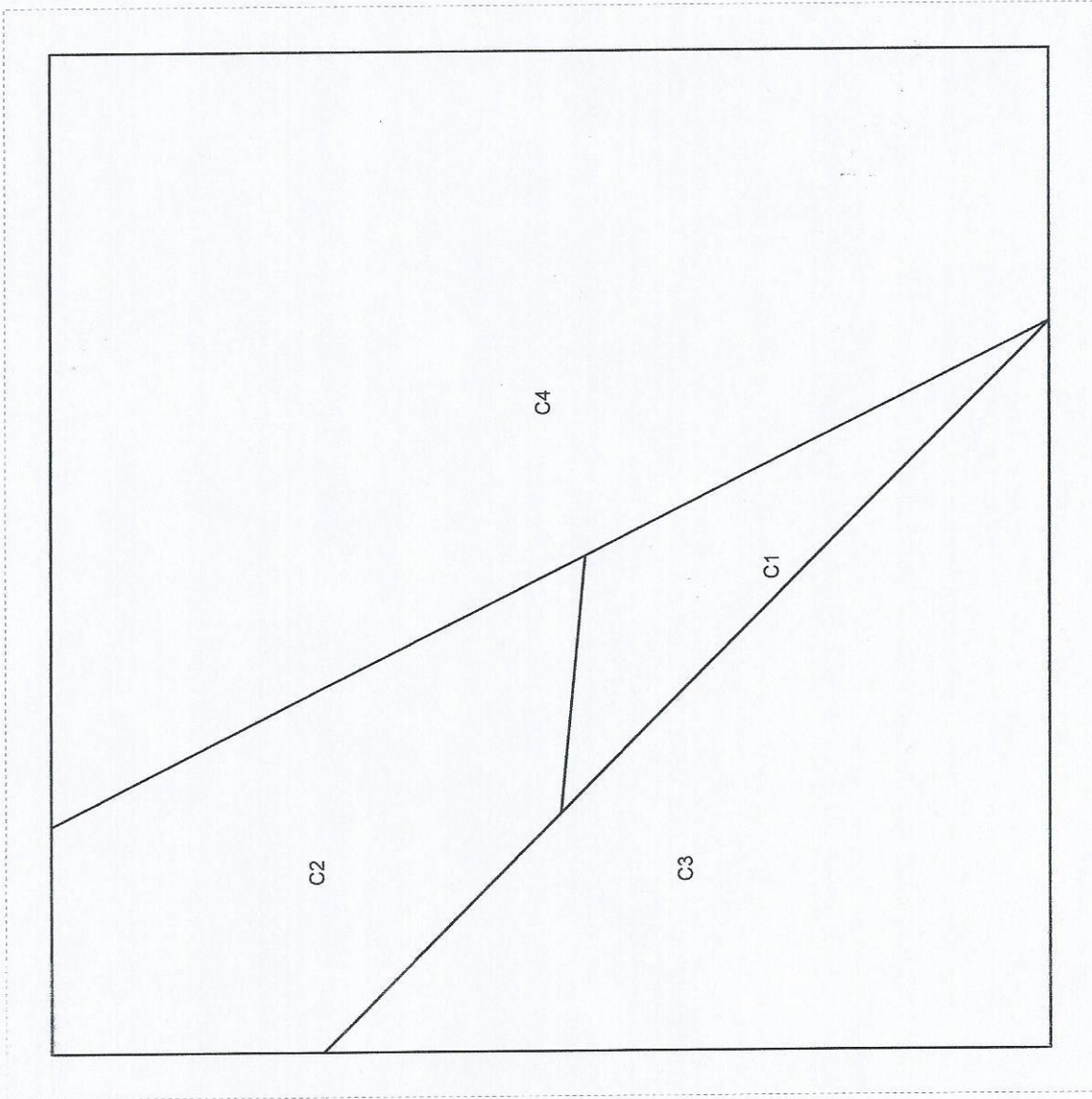

2 inches