



**JUNE BOM**  
**Easy Peasy Lemon Squeasy**

**Cutting:**

**White** (tone on tone):

1 X 4 ½" X 12 ½" Rectangle

2 - 4 ½" Squares

2 - 5" Squares

**Green** (tone on tone):

5" Square

**Yellow** (4 different tone on tone):

2 - 4 ½" squares

2 - 5 Squares

1. Print template making sure your settings are set for actual size. The box should measure 1 inch.
2. Carefully cut out templates A (W) & B (Y), set aside the leaf to trace later.
3. Cut 2 template A's using the 2 white 5" squares. Cut 2 template B's using 2 yellow 5" squares.
4. Crease the center of template A right sides together. Crease the center of templates B wrong sides together. This way the creases will fall nicely into one another.



5. Pin Template A to B right sides together on creased centerfolds. I like to use acorn piecing glue to secure each end securely and keep the right angles aligned as pictured.



- Place the block under the foot and needle down into the fabric with the concave curve (template A on top), see pic. Using tweezers or an awl pull the concave curve over to match exactly 1:1 the convex (template B) curve. Sew  $\frac{1}{4}$ " until you reach the center pin. Stop with the needle down, remove center pin. Reposition and match the rest of the curve and finish the seam. I use a shorter stitch length 2.0 for a smoother curve. Easy Peasey!! See pics for reference.



- Press to the light.
- Trim to  $4\frac{1}{2}$ " square making sure you have your  $2 - \frac{1}{4}$ " seams allowance. See pics for reference.

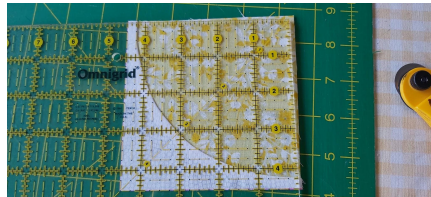

- Sew all of the  $4\frac{1}{2}$ " squares together as shown in photos. Alternate seams for nice nesting, swirl seams to reduce bulk.

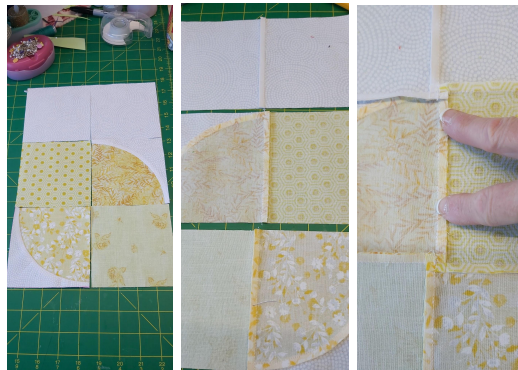

10. Join the 4 ½"X 12 1'2" rectangle to the left side of the 6 patch. **Press and true to 12 ½" square.**
11. Using your favorite applique method, trace and cut your green leaf. I prefer a turned edge. Trace your template onto freezer paper, fuse it to the wrong side of the green square on the diagonal, bias turns much easier just sayin!! Trim around leaving a ¼" all the way around. Brush seam allowance with starch and turn edge pressing to the paper using a small iron. Give a light starch once again. Once cool, carefully remove paper. Place onto block as pictured. Draw a 45 degree line on the white square matching angle. Place leaf snug into corner as pictured. I adhered it with a gluestick to keep into place. Use a 2.0L, 2.0W zigzag with a matching thread.

